

# به نام خدا

## مشخصات ساختمان:

- ۱- مالک :
  - ۲- محل ساخت:
  - ۳- نوع کاربردی ساختمان: مسکونی
  - ۴- نوع اسکلت ساختمان: بتنی
  - ۵- تعداد طبقات: ۴ طبقه
  - ۶- نوع سقف: تیرچه و بلوک یونولیت (پلی استایرن)
  - ۷- سیستم مقاوم در برابر زلزله در جهت  $X$ : قاب خمشی
  - ۸- سیستم مقاوم در برابر زلزله در جهت  $Y$ : قاب خمشی
- ضوابط و آیین نامه ها و نرم افزارهای مورد استفاده در محاسبات:

۱- آیین نامه طرر ساختمانها در برابر زلزله ایران ( ۲۸۰۰ ) ویرایش چهارم

۲- آیین نامه ACI-318

۳- برنامه کامپیوتری SAFE

۴- برنامه کامپیوتری ETABS

۵- برنامه کامپیوتری AUTO CAD

۶- بتن مصرفی از نوع B350 (تیپ II) با مقاومت  $f'_c = 210 \text{ kg/cm}^2$  می باشد.

۷- کلیه پروفیلهای مصرفی از نوع A III با حد جاری شدن  $F_y = 4000 \text{ kg/cm}^2$  می باشد.

۸- مقاومت مجاز خاک زیر فداسیون برابر  $Q_a = 0.85 \text{ kg/cm}^2$  در نظر گرفته شده است می باشد.

۹- عیار بتن مصرفی در بتن مگر Bn 150 م ظهور می گردد.

# بارگذاری

## جزئیات سقف ۱:

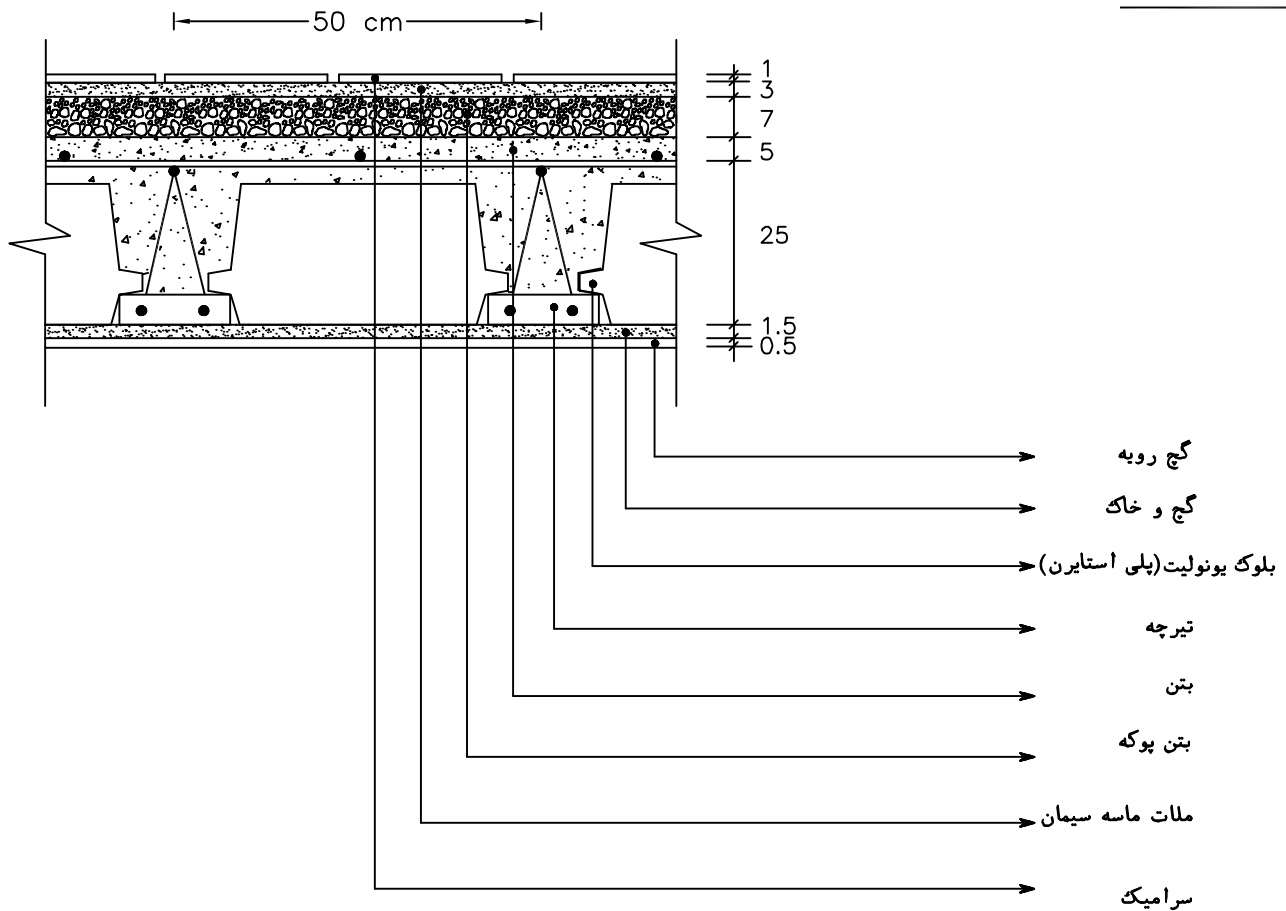

$$0.01 \times 2000 = 20 \text{ kg/m}^2 \quad \text{سرامیک}$$

$$0.025 \times 2100 = 52.5 \text{ kg/m}^2 \quad \text{ملات ماسه سیمان}$$

$$[(0.05 \times 0.5 + 0.25 \times 0.1) \times 2500] \times 2 + 3.5 = 253.5 \text{ kg/m}^2 \quad \text{تیرچه و بلوک یونولیت (پلی استایرن)}$$

$$0.07 \times 1300 = 91 \text{ kg/m}^2 \quad \text{بتن پوک}$$

$$0.015 \times 1600 = 24 \text{ kg/m}^2 \quad \text{گچ و خاک}$$

$$0.005 \times 1300 = 6.50 \text{ kg/m}^2 \quad \text{گچ رویه}$$

$$\text{جمع کل} \quad 450 \text{ kg/m}^2$$

## جزئیات پله :

سنگ پلاک ۳

ملات ماسه سیمان

بتن و خرده آجر

دال بتنی

گچ و خاک

گچ رویه

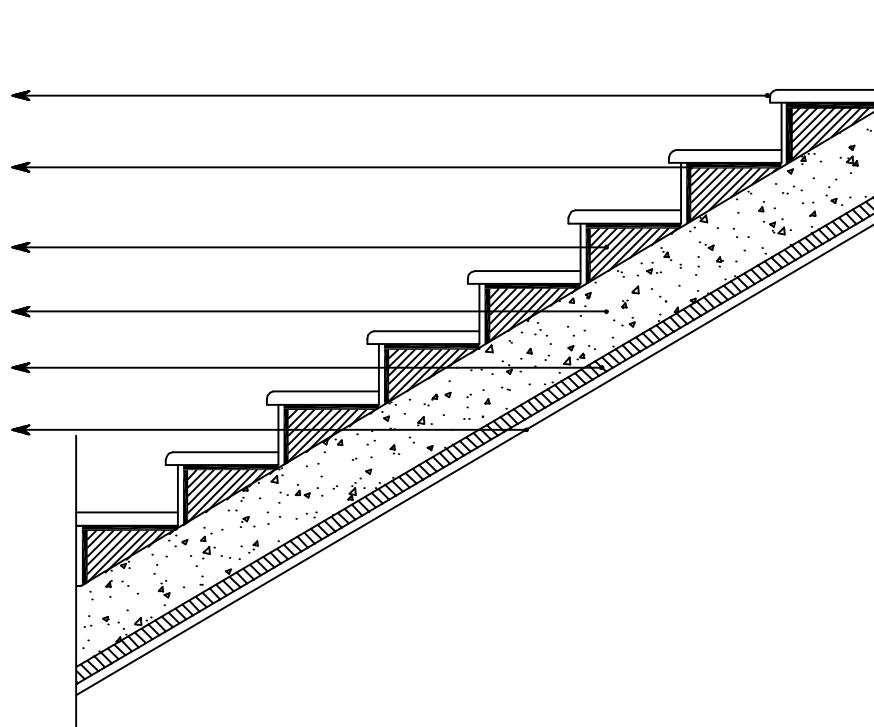

|       |   |                          |      |      |                 |
|-------|---|--------------------------|------|------|-----------------|
| 97.20 | 4 | 0.03                     | 0.30 | 2700 | سنگ پلاک        |
| 63    | 4 | 0.03                     | 0.25 | 2100 | ملات ماسه سیمان |
| 133   | 4 | $(0.23 \times 0.17) / 2$ |      | 1700 | بتن و خرده آجر  |
| 375   | 1 | 0.15                     | 1.00 | 2500 | دال بتنی        |
| 24    | 1 | 0.015                    | 1.00 | 1600 | گچ و خاک        |
| 13    | 1 | 0.01                     | 1.00 | 1300 | گچ رویه         |

جمع کل 698.2  $\simeq$  700 kg/m<sup>2</sup>

## جزئیات دیوار خارجی بدون سنگ نما:

0.5 1.5 20

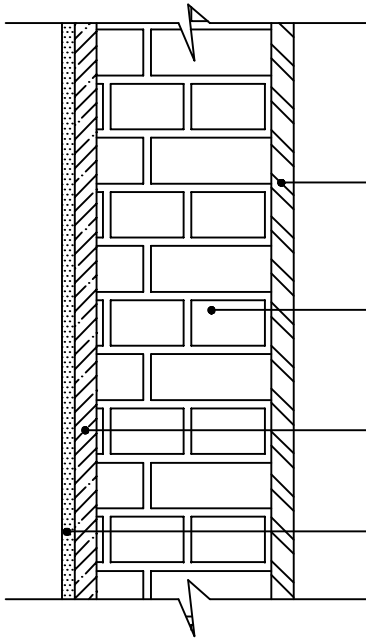

ملات ماسه سیمان  $0.015 \times 2100 = 31.5 \text{ kg/m}^2$

آجر مجوف  $0.2 \times 850 = 170 \text{ kg/m}^2$

گچ خاک  $0.015 \times 1600 = 24 \text{ kg/m}^2$

گچ رویه  $0.005 \times 1300 = 6.50 \text{ kg/m}^2$

جمع:  $232 \text{ kg/m}^2$

$232 \times (3.24 - 0.30) = 700$

## جزئیات دیوار خارجی :

0.51.5      20      1.51.5

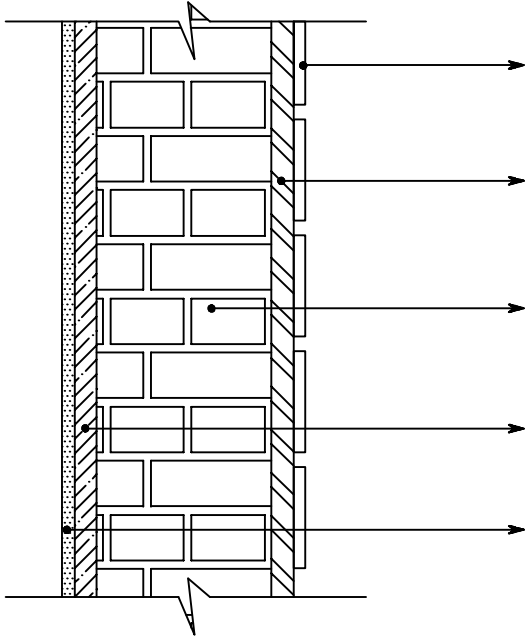

سنگ تراورتن  $0.015 \times 2500 = 37.5 \text{ kg/m}^2$

ملات ماسه سیمان  $0.015 \times 2100 = 31.5 \text{ kg/m}^2$

آجر مجوف  $0.2 \times 850 = 170 \text{ kg/m}^2$

گچ خاک  $0.015 \times 1600 = 24 \text{ kg/m}^2$

گچ رویه  $0.005 \times 1300 = 6.50 \text{ kg/m}^2$

جمع:  $269.5 \text{ kg/m}^2$

## جزئیات دیوار داخلی :

0.51      10      1 0.5

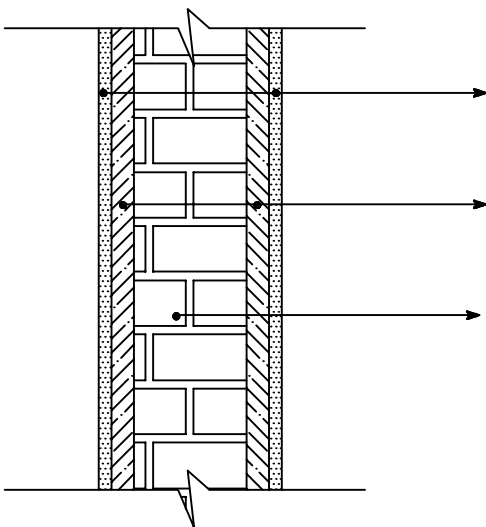

گچ رویه  $0.01 \times 1300 = 13 \text{ kg/m}^2$

گچ خاک  $0.02 \times 1600 = 32 \text{ kg/m}^2$

آجر مجوف  $0.1 \times 850 = 85 \text{ kg/m}^2$

جمع:  $130 \text{ kg/m}^2$

بار زلزله :

$$A = 0.30$$

$$I = 1.00$$

$$R_{ux} = 5$$

$$R_{uy} = 5$$

$$S = 1.75$$

$$IV \left| \begin{array}{l} T_s = 1.00 \\ T_0 = 0.15 \end{array} \right.$$

$$T_x = 0.05H^{0.9} = 0.05 \times 15.96^{0.9} = 0.61 \quad N=1 \quad C_{dx}=4.5$$

$$T_y = 0.05H^{0.9} = 0.05 \times 15.96^{0.9} = 0.61 \quad K=1.05 \quad C_{dy}=4.5$$

$$T_0 < T_x < T_s \Rightarrow B_{1x} = S+1 = 1.75+1 = 2.75$$

$$T_0 < T_y < T_s \Rightarrow B_{1y} = S+1 = 1.75+1 = 2.75$$

$$C = (ABI)/R \Rightarrow \left\{ \begin{array}{l} C_x = (AB_x I)/R_x = 0.165 \\ C_y = (AB_y I)/R_y = 0.165 \end{array} \right.$$

$$(\text{Drift})_x \leq 0.00555$$

$$(\text{Drift})_y \leq 0.00555$$

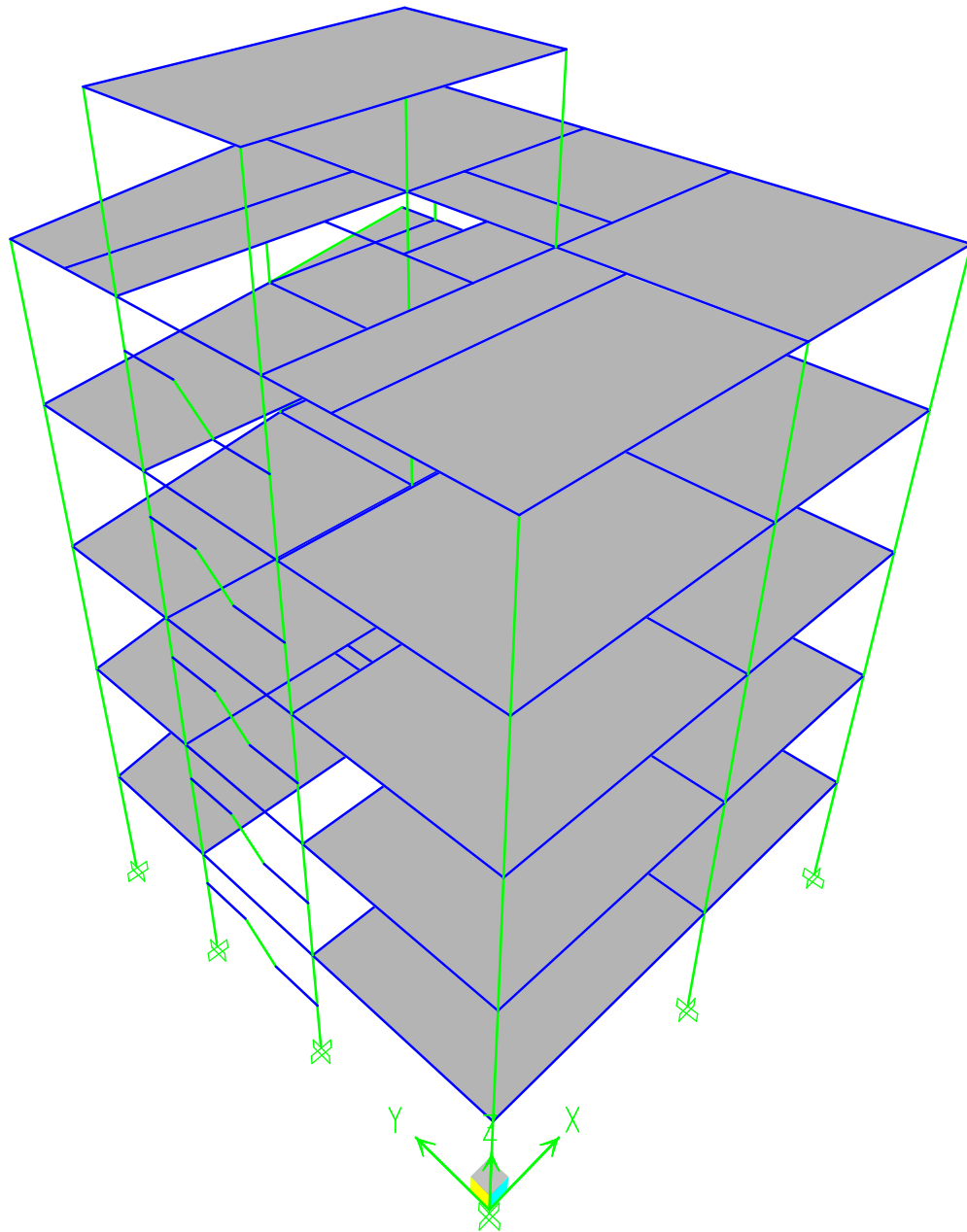

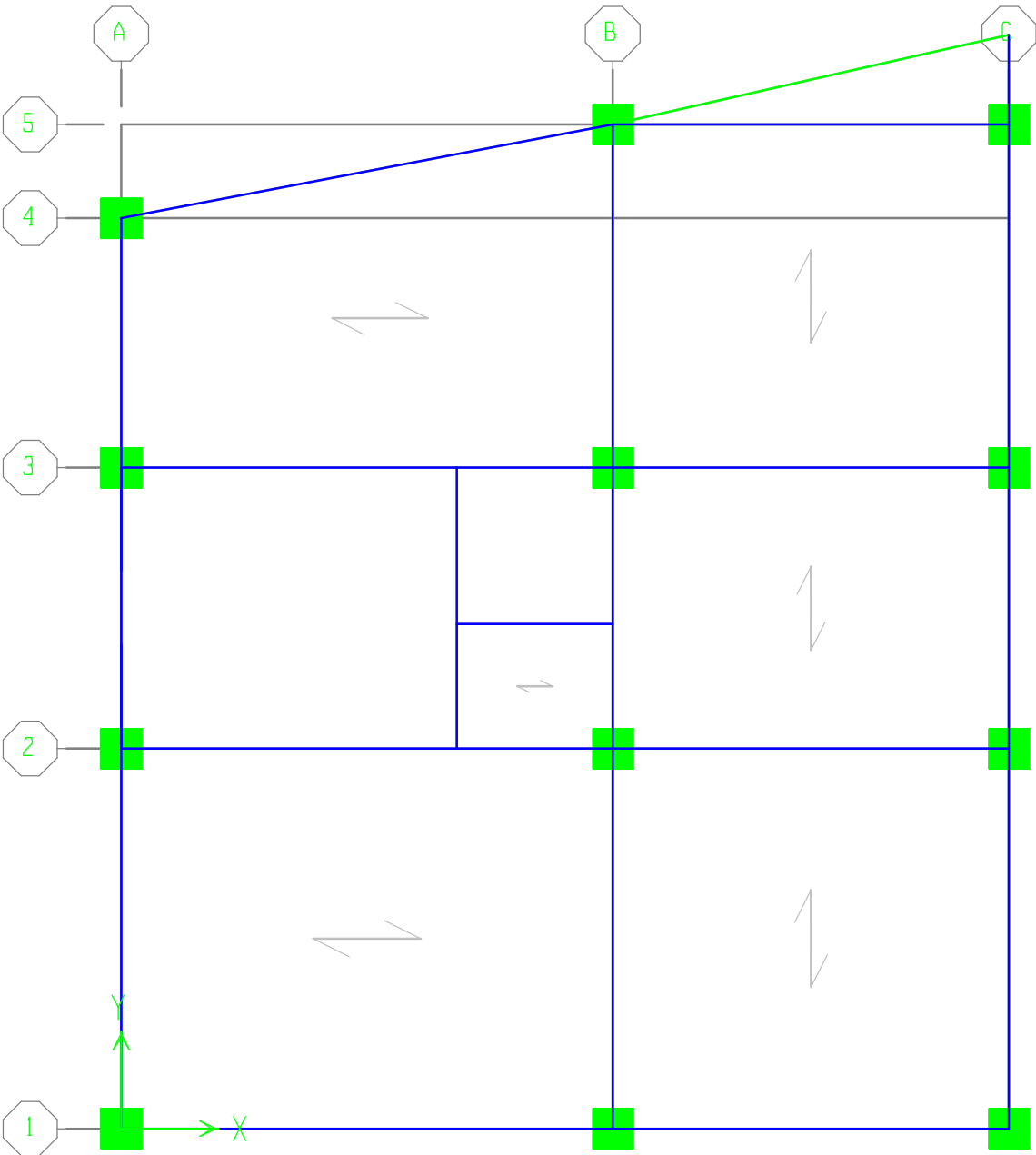



ETABS v9.7.4 File:01 Units: Ton-m April 26, 2016 14:06 PAGE 1

## S T O R Y D A T A

| STORY  | SIMILAR TO | HEIGHT | ELEVATION |
|--------|------------|--------|-----------|
| STORY6 | None       | 3.240  | 19.200    |
| STORY5 | None       | 3.240  | 15.960    |
| STORY4 | STORY1     | 3.240  | 12.720    |
| STORY3 | STORY1     | 3.240  | 9.480     |
| STORY2 | STORY1     | 3.240  | 6.240     |
| STORY1 | None       | 3.000  | 3.000     |
| BASE   | None       |        | 0.000     |

ETABS v9.7.4 File:01 Units: Ton-m April 26, 2016 14:06 PAGE 2

## M A S S S O U R C E D A T A

|           |                   |                      |
|-----------|-------------------|----------------------|
| MASS FROM | LATERAL MASS ONLY | LUMP MASS AT STORIES |
|-----------|-------------------|----------------------|

|       |     |     |
|-------|-----|-----|
| Loads | Yes | Yes |
|-------|-----|-----|

## M A S S S O U R C E L O A D S

| LOAD | MULTIPLIER |
|------|------------|
| DEAD | 1.0000     |
| LIVE | 0.2000     |
| WALL | 1.0000     |
| LW   | 1.0000     |
| LRED | 0.2000     |
| LO5  | 0.2000     |
| S    | 0.2000     |

## C O N C R E T E C O L U M N D A T A

| FRAME SECTION NAME | REINF CONFIGURATION |         | REINF SIZE/TYPE | NUM BARS 3DIR/2DIR | NUM BARS CIRCULAR | BAR COVER |
|--------------------|---------------------|---------|-----------------|--------------------|-------------------|-----------|
|                    | LONGIT              | LATERAL |                 |                    |                   |           |
| C50-16F22          | Rectangul ar        | Ti es   | 220/Check       | 5/5                | N/A               | 0.0650    |
| C50-16F20          | Rectangul ar        | Ti es   | 200/Check       | 5/5                | N/A               | 0.0650    |
| C50-12F22          | Rectangul ar        | Ti es   | 220/Check       | 4/4                | N/A               | 0.0650    |
| C50-12F20          | Rectangul ar        | Ti es   | 200/Check       | 4/4                | N/A               | 0.0650    |
| C50-8F22           | Rectangul ar        | Ti es   | 220/Check       | 3/3                | N/A               | 0.0650    |
| C50-8F20           | Rectangul ar        | Ti es   | 200/Check       | 3/3                | N/A               | 0.0650    |
| C45-16F22          | Rectangul ar        | Ti es   | 220/Check       | 5/5                | N/A               | 0.0650    |
| C45-16F20          | Rectangul ar        | Ti es   | 200/Check       | 5/5                | N/A               | 0.0650    |
| C45-12F22          | Rectangul ar        | Ti es   | 220/Check       | 4/4                | N/A               | 0.0650    |
| C45-12F20          | Rectangul ar        | Ti es   | 200/Check       | 4/4                | N/A               | 0.0650    |
| C45-8F22           | Rectangul ar        | Ti es   | 220/Check       | 3/3                | N/A               | 0.0650    |
| C45-8F20           | Rectangul ar        | Ti es   | 200/Check       | 3/3                | N/A               | 0.0650    |
| C45-8F18           | Rectangul ar        | Ti es   | 180/Check       | 3/3                | N/A               | 0.0650    |
| C40-12F22          | Rectangul ar        | Ti es   | 220/Check       | 4/4                | N/A               | 0.0650    |
| C40-12F20          | Rectangul ar        | Ti es   | 200/Check       | 4/4                | N/A               | 0.0650    |
| C40-8F22           | Rectangul ar        | Ti es   | 220/Check       | 3/3                | N/A               | 0.0650    |
| C40-8F20           | Rectangul ar        | Ti es   | 200/Check       | 3/3                | N/A               | 0.0650    |
| C40-8F18           | Rectangul ar        | Ti es   | 180/Check       | 3/3                | N/A               | 0.0650    |
| C40-8F16           | Rectangul ar        | Ti es   | 160/Check       | 3/3                | N/A               | 0.0650    |
| C35-8F22           | Rectangul ar        | Ti es   | 220/Check       | 3/3                | N/A               | 0.0650    |
| C35-8F20           | Rectangul ar        | Ti es   | 200/Check       | 3/3                | N/A               | 0.0650    |
| C35-8F18           | Rectangul ar        | Ti es   | 180/Check       | 3/3                | N/A               | 0.0650    |
| C35-8F16           | Rectangul ar        | Ti es   | 160/Check       | 3/3                | N/A               | 0.0650    |
| C35-8F14           | Rectangul ar        | Ti es   | 140/Check       | 3/3                | N/A               | 0.0650    |
| C30-8F20           | Rectangul ar        | Ti es   | 200/Check       | 3/3                | N/A               | 0.0650    |

|           |                  |           |     |     |        |
|-----------|------------------|-----------|-----|-----|--------|
|           |                  | IN.txt    |     |     |        |
| C30-8F18  | Rectangular Ties | 180/Check | 3/3 | N/A | 0.0650 |
| C30-8F16  | Rectangular Ties | 160/Check | 3/3 | N/A | 0.0650 |
| C30-8F14  | Rectangular Ties | 140/Check | 3/3 | N/A | 0.0650 |
| C55-16F22 | Rectangular Ties | 220/Check | 5/5 | N/A | 0.0650 |
| C50-16F24 | Rectangular Ties | 240/Check | 5/5 | N/A | 0.0650 |

# C O N C R E T E   B E A M   D A T A

| FRAME SECTION NAME | TOP COVER | BOT COVER | TOP LEFT AREA | TOP RIGHT AREA | BOT LEFT AREA | BOT RIGHT AREA |
|--------------------|-----------|-----------|---------------|----------------|---------------|----------------|
| B50X50             | 0.0650    | 0.0650    | 0.000         | 0.000          | 0.000         | 0.000          |
| B35X35             | 0.0650    | 0.0650    | 0.000         | 0.000          | 0.000         | 0.000          |
| B30X30             | 0.0650    | 0.0650    | 0.000         | 0.000          | 0.000         | 0.000          |
| B35X25             | 0.0650    | 0.0650    | 0.000         | 0.000          | 0.000         | 0.000          |
| B30X25             | 0.0650    | 0.0650    | 0.000         | 0.000          | 0.000         | 0.000          |
| B30X35             | 0.0650    | 0.0650    | 0.000         | 0.000          | 0.000         | 0.000          |
| B35X40             | 0.0650    | 0.0650    | 0.000         | 0.000          | 0.000         | 0.000          |
| B40X45             | 0.0650    | 0.0650    | 0.000         | 0.000          | 0.000         | 0.000          |
| B35X30             | 0.0650    | 0.0650    | 0.000         | 0.000          | 0.000         | 0.000          |
| B40X40             | 0.0650    | 0.0650    | 0.000         | 0.000          | 0.000         | 0.000          |
| B40X25             | 0.0650    | 0.0650    | 0.000         | 0.000          | 0.000         | 0.000          |
| B40X50             | 0.0650    | 0.0650    | 0.000         | 0.000          | 0.000         | 0.000          |
| B45X45             | 0.0650    | 0.0650    | 0.000         | 0.000          | 0.000         | 0.000          |
| B45X40             | 0.0650    | 0.0650    | 0.000         | 0.000          | 0.000         | 0.000          |
| B45X25             | 0.0650    | 0.0650    | 0.000         | 0.000          | 0.000         | 0.000          |
| B45X30             | 0.0650    | 0.0650    | 0.000         | 0.000          | 0.000         | 0.000          |
| B40X30             | 0.0650    | 0.0650    | 0.000         | 0.000          | 0.000         | 0.000          |
| DUBL               | 0.0300    | 0.0300    | 0.000         | 0.000          | 0.000         | 0.000          |
| B50X25             | 0.0650    | 0.0650    | 0.000         | 0.000          | 0.000         | 0.000          |
| B45X50             | 0.0650    | 0.0650    | 0.000         | 0.000          | 0.000         | 0.000          |
| B40X35             | 0.0650    | 0.0650    | 0.000         | 0.000          | 0.000         | 0.000          |
| B50X45             | 0.0650    | 0.0650    | 0.000         | 0.000          | 0.000         | 0.000          |
| B55X50             | 0.0650    | 0.0650    | 0.000         | 0.000          | 0.000         | 0.000          |
| B55X25             | 0.0650    | 0.0650    | 0.000         | 0.000          | 0.000         | 0.000          |

ETABS v9.7.4 File:01 Units: Ton-m April 26, 2016 14:06 PAGE 10

# S T A T I C   L O A D   C A S E S

| STATIC CASE | CASE TYPE   | AUTO LAT LOAD | SELF WT MULTIPLIER | NOTIONAL FACTOR | NOTIONAL DIRECTION |
|-------------|-------------|---------------|--------------------|-----------------|--------------------|
| LIVE        | LIVE        | N/A           | 0.0000             |                 |                    |
| EY          | QUAKE       | USER_COEFF    | 0.0000             |                 |                    |
| EZ          | OTHER       | N/A           | 0.0000             |                 |                    |
| WALL        | OTHER       | N/A           | 0.0000             |                 |                    |
| EXP         | QUAKE       | USER_COEFF    | 0.0000             |                 |                    |
| EYP         | QUAKE       | USER_COEFF    | 0.0000             |                 |                    |
| EYN         | QUAKE       | USER_COEFF    | 0.0000             |                 |                    |
| LW          | LIVE        | N/A           | 0.0000             |                 |                    |
| LRED        | REDUCE LIVE | N/A           | 0.0000             |                 |                    |
| L05         | REDUCE LIVE | N/A           | 0.0000             |                 |                    |
| S           | SNOW        | N/A           | 0.0000             |                 |                    |

ETABS v9.7.4 File:01 Units: Ton-m April 26, 2016 14:06 PAGE 11

# L O A D I N G   C O M B I N A T I O N S

| COMBO | COMBO TYPE | CASE | CASE TYPE | SCALE FACTOR |
|-------|------------|------|-----------|--------------|
| COMB1 | ADD        | DEAD | Static    | 1.4000       |
| COMB2 | ADD        | DEAD | Static    | 1.2000       |
|       |            | LIVE | Static    | 1.6000       |
|       |            | LW   | Static    | 1.6000       |
|       |            | L05  | Static    | 1.6000       |

|        |     |      |        |         |
|--------|-----|------|--------|---------|
|        |     |      |        | IN.txt  |
|        |     | LRED | Static | 1.6000  |
|        |     | S    | Static | 0.5000  |
| COMB3  | ADD | DEAD | Static | 1.2000  |
|        |     | LIVE | Static | 1.0000  |
|        |     | LW   | Static | 1.0000  |
|        |     | LRED | Static | 1.0000  |
|        |     | LO5  | Static | 0.5000  |
|        |     | S    | Static | 0.2000  |
|        |     | EX   | Static | 1.0000  |
|        |     | EY   | Static | 0.3000  |
|        |     | EZ   | Static | 1.0000  |
| COMB4  | ADD | DEAD | Static | 1.2000  |
|        |     | LIVE | Static | 1.0000  |
|        |     | LW   | Static | 1.0000  |
|        |     | LRED | Static | 1.0000  |
|        |     | LO5  | Static | 0.5000  |
|        |     | S    | Static | 0.2000  |
|        |     | EX   | Static | 1.0000  |
|        |     | EY   | Static | -0.3000 |
|        |     | EZ   | Static | 1.0000  |
| COMB5  | ADD | DEAD | Static | 1.2000  |
|        |     | LIVE | Static | 1.0000  |
|        |     | LW   | Static | 1.0000  |
|        |     | LRED | Static | 1.0000  |
|        |     | LO5  | Static | 0.5000  |
|        |     | S    | Static | 0.2000  |
|        |     | EX   | Static | 1.0000  |
|        |     | EY   | Static | 0.3000  |
|        |     | EZ   | Static | -1.0000 |
| COMB6  | ADD | DEAD | Static | 1.2000  |
|        |     | LIVE | Static | 1.0000  |
|        |     | LW   | Static | 1.0000  |
|        |     | LRED | Static | 1.0000  |
|        |     | LO5  | Static | 0.5000  |
|        |     | S    | Static | 0.2000  |
|        |     | EX   | Static | 1.0000  |
|        |     | EY   | Static | -0.3000 |
|        |     | EZ   | Static | -1.0000 |
| COMB7  | ADD | DEAD | Static | 1.2000  |
|        |     | LIVE | Static | 1.0000  |
|        |     | LW   | Static | 1.0000  |
|        |     | LRED | Static | 1.0000  |
|        |     | LO5  | Static | 0.5000  |
|        |     | S    | Static | 0.2000  |
|        |     | EX   | Static | -1.0000 |
|        |     | EY   | Static | 0.3000  |
|        |     | EZ   | Static | 1.0000  |
| COMB8  | ADD | DEAD | Static | 1.2000  |
|        |     | LIVE | Static | 1.0000  |
|        |     | LW   | Static | 1.0000  |
|        |     | LRED | Static | 1.0000  |
|        |     | LO5  | Static | 0.5000  |
|        |     | S    | Static | 0.2000  |
|        |     | EX   | Static | -1.0000 |
|        |     | EY   | Static | -0.3000 |
|        |     | EZ   | Static | 1.0000  |
| COMB9  | ADD | DEAD | Static | 1.2000  |
|        |     | LIVE | Static | 1.0000  |
|        |     | LW   | Static | 1.0000  |
|        |     | LRED | Static | 1.0000  |
|        |     | LO5  | Static | 0.5000  |
|        |     | S    | Static | 0.2000  |
|        |     | EX   | Static | -1.0000 |
|        |     | EY   | Static | 0.3000  |
|        |     | EZ   | Static | -1.0000 |
| COMB10 | ADD | DEAD | Static | 1.2000  |
|        |     | LIVE | Static | 1.0000  |
|        |     | LW   | Static | 1.0000  |
|        |     | LRED | Static | 1.0000  |

|        |     |      |                |
|--------|-----|------|----------------|
|        |     |      | IN.txt         |
|        |     | L05  | Static 0.5000  |
|        |     | S    | Static 0.2000  |
|        |     | EX   | Static -1.0000 |
|        |     | EY   | Static -0.3000 |
|        |     | EZ   | Static -1.0000 |
| COMB11 | ADD | DEAD | Static 1.2000  |
|        |     | LIVE | Static 1.0000  |
|        |     | LW   | Static 1.0000  |
|        |     | LRED | Static 1.0000  |
|        |     | L05  | Static 0.5000  |
|        |     | S    | Static 0.2000  |
|        |     | EY   | Static 1.0000  |
|        |     | EX   | Static 0.3000  |
|        |     | EZ   | Static 1.0000  |
| COMB12 | ADD | DEAD | Static 1.2000  |
|        |     | LIVE | Static 1.0000  |
|        |     | LW   | Static 1.0000  |
|        |     | LRED | Static 1.0000  |
|        |     | L05  | Static 0.5000  |
|        |     | S    | Static 0.2000  |
|        |     | EY   | Static 1.0000  |
|        |     | EX   | Static -0.3000 |
|        |     | EZ   | Static 1.0000  |
| COMB13 | ADD | DEAD | Static 1.2000  |
|        |     | LIVE | Static 1.0000  |
|        |     | LW   | Static 1.0000  |
|        |     | LRED | Static 1.0000  |
|        |     | L05  | Static 0.5000  |
|        |     | S    | Static 0.2000  |
|        |     | EY   | Static 1.0000  |
|        |     | EX   | Static 0.3000  |
|        |     | EZ   | Static -1.0000 |
| COMB14 | ADD | DEAD | Static 1.2000  |
|        |     | LIVE | Static 1.0000  |
|        |     | LW   | Static 1.0000  |
|        |     | LRED | Static 1.0000  |
|        |     | L05  | Static 0.5000  |
|        |     | S    | Static 0.2000  |
|        |     | EY   | Static 1.0000  |
|        |     | EX   | Static -0.3000 |
|        |     | EZ   | Static -1.0000 |
| COMB15 | ADD | DEAD | Static 1.2000  |
|        |     | LIVE | Static 1.0000  |
|        |     | LW   | Static 1.0000  |
|        |     | LRED | Static 1.0000  |
|        |     | L05  | Static 0.5000  |
|        |     | S    | Static 0.2000  |
|        |     | EY   | Static -1.0000 |
|        |     | EX   | Static 0.3000  |
|        |     | EZ   | Static 1.0000  |
| COMB16 | ADD | DEAD | Static 1.2000  |
|        |     | LIVE | Static 1.0000  |
|        |     | LW   | Static 1.0000  |
|        |     | LRED | Static 1.0000  |
|        |     | L05  | Static 0.5000  |
|        |     | S    | Static 0.2000  |
|        |     | EY   | Static -1.0000 |
|        |     | EX   | Static -0.3000 |
|        |     | EZ   | Static 1.0000  |
| COMB17 | ADD | DEAD | Static 1.2000  |
|        |     | LIVE | Static 1.0000  |
|        |     | LW   | Static 1.0000  |
|        |     | LRED | Static 1.0000  |
|        |     | L05  | Static 0.5000  |
|        |     | S    | Static 0.2000  |
|        |     | EY   | Static -1.0000 |
|        |     | EX   | Static 0.3000  |
|        |     | EZ   | Static -1.0000 |
| COMB18 | ADD | DEAD | Static 1.2000  |

|        |     |      |        |         |
|--------|-----|------|--------|---------|
|        |     |      |        | IN.txt  |
|        |     | LIVE | Static | 1.0000  |
|        |     | LW   | Static | 1.0000  |
|        |     | LRED | Static | 1.0000  |
|        |     | LO5  | Static | 0.5000  |
|        |     | S    | Static | 0.2000  |
|        |     | EY   | Static | -1.0000 |
|        |     | EX   | Static | -0.3000 |
|        |     | EZ   | Static | -1.0000 |
| COMB19 | ADD | DEAD | Static | 0.9000  |
|        |     | EX   | Static | 1.0000  |
|        |     | EY   | Static | 0.3000  |
|        |     | EZ   | Static | 1.0000  |
| COMB20 | ADD | DEAD | Static | 0.9000  |
|        |     | EX   | Static | 1.0000  |
|        |     | EY   | Static | -0.3000 |
|        |     | EZ   | Static | 1.0000  |
| COMB21 | ADD | DEAD | Static | 0.9000  |
|        |     | EX   | Static | 1.0000  |
|        |     | EY   | Static | 0.3000  |
|        |     | EZ   | Static | -1.0000 |
| COMB22 | ADD | DEAD | Static | 0.9000  |
|        |     | EX   | Static | 1.0000  |
|        |     | EY   | Static | -0.3000 |
|        |     | EZ   | Static | -1.0000 |
| COMB23 | ADD | DEAD | Static | 0.9000  |
|        |     | EX   | Static | -1.0000 |
|        |     | EY   | Static | 0.3000  |
|        |     | EZ   | Static | 1.0000  |
| COMB24 | ADD | DEAD | Static | 0.9000  |
|        |     | EX   | Static | -1.0000 |
|        |     | EY   | Static | -0.3000 |
|        |     | EZ   | Static | 1.0000  |
| COMB25 | ADD | DEAD | Static | 0.9000  |
|        |     | EX   | Static | -1.0000 |
|        |     | EY   | Static | 0.3000  |
|        |     | EZ   | Static | -1.0000 |
| COMB26 | ADD | DEAD | Static | 0.9000  |
|        |     | EX   | Static | -1.0000 |
|        |     | EY   | Static | -0.3000 |
|        |     | EZ   | Static | -1.0000 |
| COMB27 | ADD | DEAD | Static | 0.9000  |
|        |     | EY   | Static | 1.0000  |
|        |     | EX   | Static | 0.3000  |
|        |     | EZ   | Static | 1.0000  |
| COMB28 | ADD | DEAD | Static | 0.9000  |
|        |     | EY   | Static | 1.0000  |
|        |     | EX   | Static | -0.3000 |
|        |     | EZ   | Static | 1.0000  |
| COMB29 | ADD | DEAD | Static | 0.9000  |
|        |     | EY   | Static | 1.0000  |
|        |     | EX   | Static | 0.3000  |
|        |     | EZ   | Static | -1.0000 |
| COMB30 | ADD | DEAD | Static | 0.9000  |
|        |     | EY   | Static | 1.0000  |
|        |     | EX   | Static | -0.3000 |
|        |     | EZ   | Static | -1.0000 |
| COMB31 | ADD | DEAD | Static | 0.9000  |
|        |     | EY   | Static | -1.0000 |
|        |     | EX   | Static | 0.3000  |
|        |     | EZ   | Static | 1.0000  |
| COMB32 | ADD | DEAD | Static | 0.9000  |
|        |     | EY   | Static | -1.0000 |
|        |     | EX   | Static | -0.3000 |
|        |     | EZ   | Static | 1.0000  |
| COMB33 | ADD | DEAD | Static | 0.9000  |
|        |     | EY   | Static | -1.0000 |
|        |     | EX   | Static | 0.3000  |
|        |     | EZ   | Static | -1.0000 |
| COMB34 | ADD | DEAD | Static | 0.9000  |

|    |        |         |
|----|--------|---------|
| EY | Static | IN.txt  |
| EX | Static | -1.0000 |
| EZ | Static | -0.3000 |
|    |        | -1.0000 |

ETABS v9.7.4 File:01 Units: Ton-m April 26, 2016 14:06 PAGE 12

A U T O S E I S M I C U S E R C O E F F I C I E N T  
Case: EY

#### AUTO SEISMIC INPUT DATA

Direction: Y  
Typical Eccentricity = 5%  
Eccentricity Overrides: No

Top Story: STORY6  
Bottom Story: BASE

C = 0.165  
K = 1

#### AUTO SEISMIC CALCULATION FORMULAS

$V = C W$

#### AUTO SEISMIC CALCULATION RESULTS

W Used = 1042.54

V Used = 0.165W = 172.02

#### AUTO SEISMIC STORY FORCES

| STORY  | FX   | FY    | FZ   | MX    | MY    | MZ     |
|--------|--|-------|------|-------|-------|--------|
| STORY6 | (Forces reported at X = 0.0000, Y = 0.0000, Z = 19.2000) |       |      |       |       |        |
|        | 0.00   | 7.34  | 0.00 | 0.000 | 0.000 | 23.129 |
| STORY5 | (Forces reported at X = 5.4928, Y = 6.4745, Z = 15.9600) |       |      |       |       |        |
|        | 0.00   | 50.45 | 0.00 | 2.058 | 0.000 | -8.645 |
| STORY4 | (Forces reported at X = 5.7844, Y = 6.4415, Z = 12.7200) |       |      |       |       |        |
|        | 0.00   | 44.05 | 0.00 | 1.640 | 0.000 | -7.255 |
| STORY3 | (Forces reported at X = 5.8015, Y = 6.4412, Z = 9.4800)  |       |      |       |       |        |
|        | 0.00   | 35.38 | 0.00 | 1.222 | 0.000 | -5.423 |
| STORY2 | (Forces reported at X = 5.8025, Y = 6.4414, Z = 6.2400)  |       |      |       |       |        |
|        | 0.00   | 23.54 | 0.00 | 0.804 | 0.000 | -3.570 |
| STORY1 | (Forces reported at X = 5.8050, Y = 6.4415, Z = 3.0000)  |       |      |       |       |        |
|        | 0.00   | 11.26 | 0.00 | 0.387 | 0.000 | -1.717 |

ETABS v9.7.4 File:01 Units: Ton-m April 26, 2016 14:06 PAGE 15

A U T O S E I S M I C U S E R C O E F F I C I E N T  
Case: EYN

#### AUTO SEISMIC INPUT DATA

Direction: Y - EccX

IN.txt

Typical Eccentricity = 5%  
Eccentricity Overrides: No

Top Story: STORY6  
Bottom Story: BASE

C = 0.165  
K = 1

#### AUTO SEISMIC CALCULATION FORMULAS

$$V = C W$$

#### AUTO SEISMIC CALCULATION RESULTS

W Used = 1042.54

V Used = 0.1650W = 172.02

#### AUTO SEISMIC STORY FORCES

| STORY  | FX   | FY    | FZ   | MX    | MY    | MZ      |
|--------|--|-------|------|-------|-------|---------|
| STORY6 | (Forces reported at X = 0.0000, Y = 0.0000, Z = 19.2000) |       |      |       |       |         |
|        | 0.00   | 7.34  | 0.00 | 0.000 | 0.000 | 23.129  |
| STORY5 | (Forces reported at X = 5.4928, Y = 6.4745, Z = 15.9600) |       |      |       |       |         |
|        | 0.00   | 50.45 | 0.00 | 2.058 | 0.000 | -36.457 |
| STORY4 | (Forces reported at X = 5.7844, Y = 6.4415, Z = 12.7200) |       |      |       |       |         |
|        | 0.00   | 44.05 | 0.00 | 1.640 | 0.000 | -31.604 |
| STORY3 | (Forces reported at X = 5.8015, Y = 6.4412, Z = 9.4800)  |       |      |       |       |         |
|        | 0.00   | 35.38 | 0.00 | 1.222 | 0.000 | -25.020 |
| STORY2 | (Forces reported at X = 5.8025, Y = 6.4414, Z = 6.2400)  |       |      |       |       |         |
|        | 0.00   | 23.54 | 0.00 | 0.804 | 0.000 | -16.613 |
| STORY1 | (Forces reported at X = 5.8050, Y = 6.4415, Z = 3.0000)  |       |      |       |       |         |
|        | 0.00   | 11.26 | 0.00 | 0.387 | 0.000 | -7.958  |

ETABS v9.7.4 File:01 Units: Ton-m April 26, 2016 14:06 PAGE 16

#### POINT FORCE ASSIGNMENTS TO POINT OBJECTS

| CASE | STORY  | POINT | FX   | FY   | FZ    | MX    | MY    | MZ    |
|------|--------|-------|------|------|-------|-------|-------|-------|
| EZ   | STORY5 | 14    | 0.00 | 0.00 | -0.44 | 0.000 | 0.000 | 0.000 |
| EZ   | STORY4 | 14    | 0.00 | 0.00 | -0.44 | 0.000 | 0.000 | 0.000 |
| EZ   | STORY3 | 14    | 0.00 | 0.00 | -0.44 | 0.000 | 0.000 | 0.000 |
| EZ   | STORY2 | 14    | 0.00 | 0.00 | -0.44 | 0.000 | 0.000 | 0.000 |
| EZ   | STORY1 | 14    | 0.00 | 0.00 | -0.44 | 0.000 | 0.000 | 0.000 |

ETABS v9.7.4 File:01 Units: Ton-m April 26, 2016 14:06 PAGE 17

#### DISTRIBUTED LOAD ASSIGNMENTS TO LINE OBJECTS

| LOAD CASE | STORY LEVEL | LINE ID | LOAD TYPE | LOAD DIRECTION | ABSOLUTE DISTANCE A | ABSOLUTE DISTANCE B | LOAD A PER LENGTH | LOAD B PER LENGTH |
|-----------|-------------|---------|-----------|----------------|---------------------|---------------------|-------------------|-------------------|
| LIVE      | STORY5      | B23     | Force     | Gravity        | 0.000               | 3.600               | 1.100             | 1.100             |
| LIVE      | STORY5      | B31     | Force     | Gravity        | 0.000               | 1.338               | 1.100             | 1.100             |
| LIVE      | STORY5      | B32     | Force     | Gravity        | 0.000               | 1.320               | 1.100             | 1.100             |

IN.txt

|      |        |     |       |          |       |       |       |       |
|------|--------|-----|-------|----------|-------|-------|-------|-------|
| LIVE | STORY4 | B23 | Force | Gravi ty | 0.000 | 3.600 | 1.100 | 1.100 |
| LIVE | STORY4 | B31 | Force | Gravi ty | 0.000 | 1.338 | 1.100 | 1.100 |
| LIVE | STORY4 | B32 | Force | Gravi ty | 0.000 | 1.320 | 1.100 | 1.100 |
| LIVE | STORY3 | B23 | Force | Gravi ty | 0.000 | 3.600 | 1.100 | 1.100 |
| LIVE | STORY3 | B31 | Force | Gravi ty | 0.000 | 1.338 | 1.100 | 1.100 |
| LIVE | STORY3 | B32 | Force | Gravi ty | 0.000 | 1.320 | 1.100 | 1.100 |
| LIVE | STORY2 | B23 | Force | Gravi ty | 0.000 | 3.600 | 1.100 | 1.100 |
| LIVE | STORY2 | B31 | Force | Gravi ty | 0.000 | 1.338 | 1.100 | 1.100 |
| LIVE | STORY2 | B32 | Force | Gravi ty | 0.000 | 1.320 | 1.100 | 1.100 |
| LIVE | STORY1 | B23 | Force | Gravi ty | 0.000 | 3.600 | 1.100 | 1.100 |
| LIVE | STORY1 | B31 | Force | Gravi ty | 0.000 | 1.338 | 1.100 | 1.100 |
| LIVE | STORY1 | B32 | Force | Gravi ty | 0.000 | 1.320 | 1.100 | 1.100 |
| WALL | STORY6 | B3  | Force | Gravi ty | 0.000 | 6.300 | 0.350 | 0.350 |
| WALL | STORY6 | B5  | Force | Gravi ty | 0.000 | 6.300 | 0.350 | 0.350 |
| WALL | STORY6 | B10 | Force | Gravi ty | 0.000 | 3.600 | 0.350 | 0.350 |
| WALL | STORY6 | B13 | Force | Gravi ty | 0.000 | 3.600 | 0.350 | 0.350 |
| WALL | STORY5 | B1  | Force | Gravi ty | 0.000 | 6.413 | 0.350 | 0.350 |
| WALL | STORY5 | B7  | Force | Gravi ty | 0.000 | 6.300 | 0.350 | 0.350 |
| WALL | STORY5 | B8  | Force | Gravi ty | 0.000 | 5.080 | 0.350 | 0.350 |
| WALL | STORY5 | B9  | Force | Gravi ty | 0.000 | 4.870 | 0.350 | 0.350 |
| WALL | STORY5 | B11 | Force | Gravi ty | 0.000 | 3.200 | 0.350 | 0.350 |
| WALL | STORY5 | B15 | Force | Gravi ty | 0.000 | 4.870 | 0.350 | 0.350 |
| WALL | STORY5 | B16 | Force | Gravi ty | 0.000 | 3.600 | 0.350 | 0.350 |
| WALL | STORY5 | B17 | Force | Gravi ty | 0.000 | 4.400 | 0.350 | 0.350 |
| WALL | STORY5 | B22 | Force | Gravi ty | 0.000 | 1.147 | 0.350 | 0.350 |
| LIVE | STORY5 | L2  | Force | Gravi ty | 0.000 | 1.174 | 1.100 | 1.100 |
| LIVE | STORY4 | L2  | Force | Gravi ty | 0.000 | 1.174 | 1.100 | 1.100 |
| LIVE | STORY3 | L2  | Force | Gravi ty | 0.000 | 1.174 | 1.100 | 1.100 |
| LIVE | STORY2 | L2  | Force | Gravi ty | 0.000 | 1.174 | 1.100 | 1.100 |
| LIVE | STORY1 | L2  | Force | Gravi ty | 0.000 | 1.174 | 1.100 | 1.100 |
| WALL | STORY5 | L1  | Force | Gravi ty | 0.000 | 5.208 | 0.350 | 0.350 |

ETABS v9.7.4 File: 01 Units: Ton-m April 26, 2016 14:06 PAGE 18

# UNIFORM LOAD ASSIGNMENTS TO AREA OBJECTS

| CASE | STORY  | AREA | AREATYPE | DIRECTION | LOAD   |
|------|--------|------|----------|-----------|--------|
| LIVE | STORY5 | F5   | Floor    | Gravi ty  | 0.6000 |
| LIVE | STORY5 | F10  | Floor    | Gravi ty  | 0.6000 |
| LIVE | STORY5 | F11  | Floor    | Gravi ty  | 0.6000 |
| LIVE | STORY5 | F13  | Floor    | Gravi ty  | 0.6000 |
| WALL | STORY5 | F1   | Floor    | Gravi ty  | 0.0650 |
| WALL | STORY5 | F3   | Floor    | Gravi ty  | 0.0650 |
| WALL | STORY5 | F7   | Floor    | Gravi ty  | 0.0650 |
| WALL | STORY5 | F9   | Floor    | Gravi ty  | 0.0650 |
| WALL | STORY5 | F12  | Floor    | Gravi ty  | 0.0650 |
| WALL | STORY5 | F14  | Floor    | Gravi ty  | 0.0650 |
| LW   | STORY5 | F5   | Floor    | Gravi ty  | 0.1300 |
| LW   | STORY5 | F10  | Floor    | Gravi ty  | 0.1300 |
| LW   | STORY5 | F11  | Floor    | Gravi ty  | 0.1300 |
| LW   | STORY5 | F13  | Floor    | Gravi ty  | 0.1300 |
| LW   | STORY4 | F1   | Floor    | Gravi ty  | 0.1300 |
| LW   | STORY4 | F2   | Floor    | Gravi ty  | 0.1300 |
| LW   | STORY4 | F3   | Floor    | Gravi ty  | 0.1300 |
| LW   | STORY4 | F4   | Floor    | Gravi ty  | 0.1300 |
| LW   | STORY4 | F5   | Floor    | Gravi ty  | 0.1300 |
| LW   | STORY4 | F6   | Floor    | Gravi ty  | 0.1300 |
| LW   | STORY4 | F7   | Floor    | Gravi ty  | 0.1300 |
| LW   | STORY3 | F1   | Floor    | Gravi ty  | 0.1300 |
| LW   | STORY3 | F2   | Floor    | Gravi ty  | 0.1300 |
| LW   | STORY3 | F3   | Floor    | Gravi ty  | 0.1300 |
| LW   | STORY3 | F4   | Floor    | Gravi ty  | 0.1300 |
| LW   | STORY3 | F5   | Floor    | Gravi ty  | 0.1300 |
| LW   | STORY3 | F6   | Floor    | Gravi ty  | 0.1300 |
| LW   | STORY3 | F7   | Floor    | Gravi ty  | 0.1300 |
| LW   | STORY2 | F1   | Floor    | Gravi ty  | 0.1300 |
| LW   | STORY2 | F2   | Floor    | Gravi ty  | 0.1300 |
| LW   | STORY2 | F3   | Floor    | Gravi ty  | 0.1300 |



IN.txt

|     |        |     |       |         |        |
|-----|--------|-----|-------|---------|--------|
| LW  | STORY2 | F4  | Floor | Gravity | 0.1300 |
| LW  | STORY2 | F5  | Floor | Gravity | 0.1300 |
| LW  | STORY2 | F6  | Floor | Gravity | 0.1300 |
| LW  | STORY2 | F7  | Floor | Gravity | 0.1300 |
| LW  | STORY1 | F1  | Floor | Gravity | 0.1300 |
| LW  | STORY1 | F2  | Floor | Gravity | 0.1300 |
| LW  | STORY1 | F3  | Floor | Gravity | 0.1300 |
| LW  | STORY1 | F4  | Floor | Gravity | 0.1300 |
| LW  | STORY1 | F5  | Floor | Gravity | 0.1300 |
| LW  | STORY1 | F6  | Floor | Gravity | 0.1300 |
| LW  | STORY1 | F7  | Floor | Gravity | 0.1300 |
| L05 | STORY4 | F1  | Floor | Gravity | 0.3000 |
| L05 | STORY4 | F2  | Floor | Gravity | 0.2000 |
| L05 | STORY4 | F3  | Floor | Gravity | 0.2000 |
| L05 | STORY4 | F4  | Floor | Gravity | 0.2000 |
| L05 | STORY4 | F5  | Floor | Gravity | 0.2000 |
| L05 | STORY4 | F6  | Floor | Gravity | 0.2000 |
| L05 | STORY4 | F7  | Floor | Gravity | 0.2000 |
| L05 | STORY3 | F1  | Floor | Gravity | 0.3000 |
| L05 | STORY3 | F2  | Floor | Gravity | 0.2000 |
| L05 | STORY3 | F3  | Floor | Gravity | 0.2000 |
| L05 | STORY3 | F4  | Floor | Gravity | 0.2000 |
| L05 | STORY3 | F5  | Floor | Gravity | 0.2000 |
| L05 | STORY3 | F6  | Floor | Gravity | 0.2000 |
| L05 | STORY3 | F7  | Floor | Gravity | 0.2000 |
| L05 | STORY2 | F1  | Floor | Gravity | 0.3000 |
| L05 | STORY2 | F2  | Floor | Gravity | 0.2000 |
| L05 | STORY2 | F3  | Floor | Gravity | 0.2000 |
| L05 | STORY2 | F4  | Floor | Gravity | 0.2000 |
| L05 | STORY2 | F5  | Floor | Gravity | 0.2000 |
| L05 | STORY2 | F6  | Floor | Gravity | 0.2000 |
| L05 | STORY2 | F7  | Floor | Gravity | 0.2000 |
| L05 | STORY1 | F1  | Floor | Gravity | 0.3000 |
| L05 | STORY1 | F2  | Floor | Gravity | 0.2000 |
| L05 | STORY1 | F3  | Floor | Gravity | 0.2000 |
| L05 | STORY1 | F4  | Floor | Gravity | 0.2000 |
| L05 | STORY1 | F5  | Floor | Gravity | 0.2000 |
| L05 | STORY1 | F6  | Floor | Gravity | 0.2000 |
| L05 | STORY1 | F7  | Floor | Gravity | 0.2000 |
| S   | STORY6 | F8  | Floor | Gravity | 0.2000 |
| S   | STORY5 | F1  | Floor | Gravity | 0.3000 |
| S   | STORY5 | F3  | Floor | Gravity | 0.2000 |
| S   | STORY5 | F7  | Floor | Gravity | 0.2000 |
| S   | STORY5 | F9  | Floor | Gravity | 0.2000 |
| S   | STORY5 | F12 | Floor | Gravity | 0.2000 |
| S   | STORY5 | F14 | Floor | Gravity | 0.2000 |

## D I S P L A C E M E N T S A T D I A P H R A G M C E N T E R O F M A S S

| STORY  | DIAPHRAGM | LOAD | POINT | X     | Y     | UX      | UY      | RZ       |
|--------|-----------|------|-------|-------|-------|---------|---------|----------|
| STORY5 | D1        | EX   | 113   | 5.493 | 6.474 | 0.0730  | -0.0008 | 0.00001  |
| STORY5 | D1        | EY   | 113   | 5.493 | 6.474 | -0.0008 | 0.0542  | -0.00068 |
| STORY5 | D1        | EXP  | 113   | 5.493 | 6.474 | 0.0730  | -0.0005 | -0.00075 |
| STORY5 | D1        | EXN  | 113   | 5.493 | 6.474 | 0.0730  | -0.0011 | 0.00077  |
| STORY5 | D1        | EYP  | 113   | 5.493 | 6.474 | -0.0008 | 0.0540  | -0.00006 |
| STORY5 | D1        | EYN  | 113   | 5.493 | 6.474 | -0.0008 | 0.0545  | -0.00129 |
| STORY4 | D1        | EX   | 114   | 5.784 | 6.441 | 0.0570  | -0.0006 | 0.00001  |
| STORY4 | D1        | EY   | 114   | 5.784 | 6.441 | -0.0006 | 0.0425  | -0.00049 |
| STORY4 | D1        | EXP  | 114   | 5.784 | 6.441 | 0.0570  | -0.0006 | -0.00060 |
| STORY4 | D1        | EXN  | 114   | 5.784 | 6.441 | 0.0570  | -0.0007 | 0.00062  |
| STORY4 | D1        | EYP  | 114   | 5.784 | 6.441 | -0.0006 | 0.0424  | 0.00001  |
| STORY4 | D1        | EYN  | 114   | 5.784 | 6.441 | -0.0007 | 0.0425  | -0.00098 |
| STORY3 | D1        | EX   | 115   | 5.801 | 6.441 | 0.0403  | -0.0004 | 0.00001  |
| STORY3 | D1        | EY   | 115   | 5.801 | 6.441 | -0.0004 | 0.0302  | -0.00033 |
| STORY3 | D1        | EXP  | 115   | 5.801 | 6.441 | 0.0403  | -0.0004 | -0.00043 |
| STORY3 | D1        | EXN  | 115   | 5.801 | 6.441 | 0.0403  | -0.0005 | 0.00045  |
| STORY3 | D1        | EYP  | 115   | 5.801 | 6.441 | -0.0004 | 0.0302  | 0.00003  |
| STORY3 | D1        | EYN  | 115   | 5.801 | 6.441 | -0.0005 | 0.0303  | -0.00068 |
| STORY2 | D1        | EX   | 116   | 5.802 | 6.441 | 0.0246  | -0.0002 | 0.00001  |
| STORY2 | D1        | EY   | 116   | 5.802 | 6.441 | -0.0002 | 0.0189  | -0.00020 |
| STORY2 | D1        | EXP  | 116   | 5.802 | 6.441 | 0.0246  | -0.0002 | -0.00027 |
| STORY2 | D1        | EXN  | 116   | 5.802 | 6.441 | 0.0246  | -0.0003 | 0.00028  |
| STORY2 | D1        | EYP  | 116   | 5.802 | 6.441 | -0.0002 | 0.0189  | 0.00003  |
| STORY2 | D1        | EYN  | 116   | 5.802 | 6.441 | -0.0003 | 0.0189  | -0.00042 |
| STORY1 | D1        | EX   | 117   | 5.805 | 6.441 | 0.0087  | -0.0001 | 0.00000  |
| STORY1 | D1        | EY   | 117   | 5.805 | 6.441 | -0.0001 | 0.0069  | -0.00007 |
| STORY1 | D1        | EXP  | 117   | 5.805 | 6.441 | 0.0087  | -0.0001 | -0.00010 |
| STORY1 | D1        | EXN  | 117   | 5.805 | 6.441 | 0.0087  | -0.0001 | 0.00010  |
| STORY1 | D1        | EYP  | 117   | 5.805 | 6.441 | -0.0001 | 0.0069  | 0.00001  |
| STORY1 | D1        | EYN  | 117   | 5.805 | 6.441 | -0.0001 | 0.0069  | -0.00015 |

## S T O R Y D R I F T S

| STORY  | DIRECTION | LOAD | POINT | X      | Y      | Z      | MAX DRIFT |
|--------|-----------|------|-------|--------|--------|--------|-----------|
| STORY6 | X         | EX   | 4     | 0.000  | 8.470  | 19.200 | 0.004014  |
| STORY6 | Y         | EY   | 7     | 0.000  | 4.870  | 19.200 | 0.002631  |
| STORY6 | X         | EXP  | 4     | 0.000  | 8.470  | 19.200 | 0.004043  |
| STORY6 | X         | EXN  | 7     | 0.000  | 4.870  | 19.200 | 0.004031  |
| STORY6 | Y         | EYP  | 7     | 0.000  | 4.870  | 19.200 | 0.002568  |
| STORY6 | Y         | EYN  | 7     | 0.000  | 4.870  | 19.200 | 0.002694  |
| STORY5 | X         | EX   | 26-1  | 0.000  | 6.208  | 14.304 | 0.005251  |
| STORY5 | Y         | EY   | 26-1  | 0.000  | 6.208  | 14.304 | 0.004139  |
| STORY5 | X         | EXP  | 14    | 11.380 | 14.017 | 15.960 | 0.005285  |
| STORY5 | X         | EXN  | 7-3   | 0.000  | 4.870  | 14.304 | 0.005276  |
| STORY5 | Y         | EYP  | 26-1  | 0.000  | 6.208  | 14.304 | 0.003888  |
| STORY5 | Y         | EYN  | 26-1  | 0.000  | 6.208  | 14.304 | 0.004390  |
| STORY4 | X         | EX   | 12    | 11.380 | 0.000  | 12.720 | 0.005167  |
| STORY4 | Y         | EY   | 10    | 0.000  | 0.000  | 12.720 | 0.004066  |

## DR. txt

|        |   |     |      |        |        |        |          |
|--------|---|-----|------|--------|--------|--------|----------|
| STORY4 | X | EXP | 14   | 11.380 | 14.017 | 12.720 | 0.005553 |
| STORY4 | X | EXN | 12   | 11.380 | 0.000  | 12.720 | 0.005509 |
| STORY4 | Y | EYP | 10   | 0.000  | 0.000  | 12.720 | 0.003814 |
| STORY4 | Y | EYN | 10   | 0.000  | 0.000  | 12.720 | 0.004318 |
| STORY3 | X | EX  | 26-1 | 0.000  | 6.208  | 7.824  | 0.004994 |
| STORY3 | Y | EY  | 26-1 | 0.000  | 6.208  | 7.824  | 0.003895 |
| STORY3 | X | EXP | 14   | 11.380 | 14.017 | 9.480  | 0.005203 |
| STORY3 | X | EXN | 12   | 11.380 | 0.000  | 9.480  | 0.005173 |
| STORY3 | Y | EYP | 26-1 | 0.000  | 6.208  | 7.824  | 0.003641 |
| STORY3 | Y | EYN | 26-1 | 0.000  | 6.208  | 7.824  | 0.004148 |
| STORY2 | X | EX  | 12   | 11.380 | 0.000  | 6.240  | 0.004924 |
| STORY2 | Y | EY  | 10   | 0.000  | 0.000  | 6.240  | 0.003916 |
| STORY2 | X | EXP | 14   | 11.380 | 14.017 | 6.240  | 0.005308 |
| STORY2 | X | EXN | 12   | 11.380 | 0.000  | 6.240  | 0.005273 |
| STORY2 | Y | EYP | 14   | 11.380 | 14.017 | 6.240  | 0.003714 |
| STORY2 | Y | EYN | 10   | 0.000  | 0.000  | 6.240  | 0.004173 |
| STORY1 | X | EX  | 12   | 11.380 | 0.000  | 3.000  | 0.002899 |
| STORY1 | Y | EY  | 10   | 0.000  | 0.000  | 3.000  | 0.002451 |
| STORY1 | X | EXP | 3    | 11.380 | 12.870 | 3.000  | 0.003110 |
| STORY1 | X | EXN | 12   | 11.380 | 0.000  | 3.000  | 0.003120 |
| STORY1 | Y | EYP | 12   | 11.380 | 0.000  | 3.000  | 0.002334 |
| STORY1 | Y | EYN | 10   | 0.000  | 0.000  | 3.000  | 0.002614 |

ETABS v9.7.4 File:01 Units: Ton-m April 26, 2016 14:06 PAGE 4

## D I A P H R A G M D R I F T S

| STORY  | DIAPHRAGM | DIRECTION | LOAD | POINT | X      | Y      | Z      | MAX DRIFT |
|--------|-----------|-----------|------|-------|--------|--------|--------|-----------|
| STORY5 | D1        | X         | EX   | 14    | 11.380 | 14.017 | 15.960 | 0.004933  |
| STORY5 | D1        | Y         | EX   | 14    | 11.380 | 14.017 | 15.960 | 0.000063  |
| STORY5 | D1        | X         | EY   | 12    | 11.380 | 0.000  | 15.960 | 0.000434  |
| STORY5 | D1        | Y         | EY   | 10    | 0.000  | 0.000  | 15.960 | 0.003905  |
| STORY5 | D1        | X         | EXP  | 14    | 11.380 | 14.017 | 15.960 | 0.005285  |
| STORY5 | D1        | Y         | EXP  | 12    | 11.380 | 0.000  | 15.960 | 0.000321  |
| STORY5 | D1        | X         | EXN  | 12    | 11.380 | 0.000  | 15.960 | 0.005224  |
| STORY5 | D1        | Y         | EXN  | 10    | 0.000  | 0.000  | 15.960 | 0.000327  |
| STORY5 | D1        | X         | EYP  | 12    | 11.380 | 0.000  | 15.960 | 0.000187  |
| STORY5 | D1        | Y         | EYP  | 10    | 0.000  | 0.000  | 15.960 | 0.003682  |
| STORY5 | D1        | X         | EYN  | 12    | 11.380 | 0.000  | 15.960 | 0.000681  |
| STORY5 | D1        | Y         | EYN  | 10    | 0.000  | 0.000  | 15.960 | 0.004128  |
| STORY4 | D1        | X         | EX   | 12    | 11.380 | 0.000  | 12.720 | 0.005167  |
| STORY4 | D1        | Y         | EX   | 10    | 0.000  | 0.000  | 12.720 | 0.000064  |
| STORY4 | D1        | X         | EY   | 12    | 11.380 | 0.000  | 12.720 | 0.000384  |
| STORY4 | D1        | Y         | EY   | 10    | 0.000  | 0.000  | 12.720 | 0.004066  |
| STORY4 | D1        | X         | EXP  | 14    | 11.380 | 14.017 | 12.720 | 0.005553  |
| STORY4 | D1        | Y         | EXP  | 9     | 11.380 | 4.870  | 12.720 | 0.000344  |
| STORY4 | D1        | X         | EXN  | 12    | 11.380 | 0.000  | 12.720 | 0.005509  |

|        |    |   |     |         |        |        |        |          |
|--------|----|---|-----|---------|--------|--------|--------|----------|
|        |    |   |     | DR. txt |        |        |        |          |
| STORY4 | D1 | Y | EXN | 4       | 0.000  | 8.470  | 12.720 | 0.000374 |
| STORY4 | D1 | X | EYP | 12      | 11.380 | 0.000  | 12.720 | 0.000107 |
| STORY4 | D1 | Y | EYP | 10      | 0.000  | 0.000  | 12.720 | 0.003814 |
| STORY4 | D1 | X | EYN | 12      | 11.380 | 0.000  | 12.720 | 0.000662 |
| STORY4 | D1 | Y | EYN | 10      | 0.000  | 0.000  | 12.720 | 0.004318 |
| STORY3 | D1 | X | EX  | 12      | 11.380 | 0.000  | 9.480  | 0.004847 |
| STORY3 | D1 | Y | EX  | 10      | 0.000  | 0.000  | 9.480  | 0.000067 |
| STORY3 | D1 | X | EY  | 12      | 11.380 | 0.000  | 9.480  | 0.000317 |
| STORY3 | D1 | Y | EY  | 10      | 0.000  | 0.000  | 9.480  | 0.003731 |
| STORY3 | D1 | X | EXP | 14      | 11.380 | 14.017 | 9.480  | 0.005203 |
| STORY3 | D1 | Y | EXP | 14      | 11.380 | 14.017 | 9.480  | 0.000324 |
| STORY3 | D1 | X | EXN | 12      | 11.380 | 0.000  | 9.480  | 0.005173 |
| STORY3 | D1 | Y | EXN | 10      | 0.000  | 0.000  | 9.480  | 0.000362 |
| STORY3 | D1 | X | EYP | 14      | 11.380 | 14.017 | 9.480  | 0.000064 |
| STORY3 | D1 | Y | EYP | 14      | 11.380 | 14.017 | 9.480  | 0.003500 |
| STORY3 | D1 | X | EYN | 12      | 11.380 | 0.000  | 9.480  | 0.000581 |
| STORY3 | D1 | Y | EYN | 10      | 0.000  | 0.000  | 9.480  | 0.003972 |
| STORY2 | D1 | X | EX  | 12      | 11.380 | 0.000  | 6.240  | 0.004924 |
| STORY2 | D1 | Y | EX  | 10      | 0.000  | 0.000  | 6.240  | 0.000060 |
| STORY2 | D1 | X | EY  | 12      | 11.380 | 0.000  | 6.240  | 0.000304 |
| STORY2 | D1 | Y | EY  | 10      | 0.000  | 0.000  | 6.240  | 0.003916 |
| STORY2 | D1 | X | EXP | 14      | 11.380 | 14.017 | 6.240  | 0.005308 |
| STORY2 | D1 | Y | EXP | 14      | 11.380 | 14.017 | 6.240  | 0.000339 |
| STORY2 | D1 | X | EXN | 12      | 11.380 | 0.000  | 6.240  | 0.005273 |
| STORY2 | D1 | Y | EXN | 10      | 0.000  | 0.000  | 6.240  | 0.000377 |
| STORY2 | D1 | X | EYP | 14      | 11.380 | 14.017 | 6.240  | 0.000088 |
| STORY2 | D1 | Y | EYP | 14      | 11.380 | 14.017 | 6.240  | 0.003714 |
| STORY2 | D1 | X | EYN | 12      | 11.380 | 0.000  | 6.240  | 0.000587 |
| STORY2 | D1 | Y | EYN | 10      | 0.000  | 0.000  | 6.240  | 0.004173 |
| STORY1 | D1 | X | EX  | 12      | 11.380 | 0.000  | 3.000  | 0.002899 |
| STORY1 | D1 | Y | EX  | 10      | 0.000  | 0.000  | 3.000  | 0.000028 |
| STORY1 | D1 | X | EY  | 12      | 11.380 | 0.000  | 3.000  | 0.000178 |
| STORY1 | D1 | Y | EY  | 10      | 0.000  | 0.000  | 3.000  | 0.002451 |
| STORY1 | D1 | X | EXP | 3       | 11.380 | 12.870 | 3.000  | 0.003110 |
| STORY1 | D1 | Y | EXP | 9       | 11.380 | 4.870  | 3.000  | 0.000209 |
| STORY1 | D1 | X | EXN | 12      | 11.380 | 0.000  | 3.000  | 0.003120 |
| STORY1 | D1 | Y | EXN | 10      | 0.000  | 0.000  | 3.000  | 0.000229 |
| STORY1 | D1 | X | EYP | 3       | 11.380 | 12.870 | 3.000  | 0.000051 |
| STORY1 | D1 | Y | EYP | 12      | 11.380 | 0.000  | 3.000  | 0.002334 |
| STORY1 | D1 | X | EYN | 12      | 11.380 | 0.000  | 3.000  | 0.000357 |
| STORY1 | D1 | Y | EYN | 10      | 0.000  | 0.000  | 3.000  | 0.002614 |

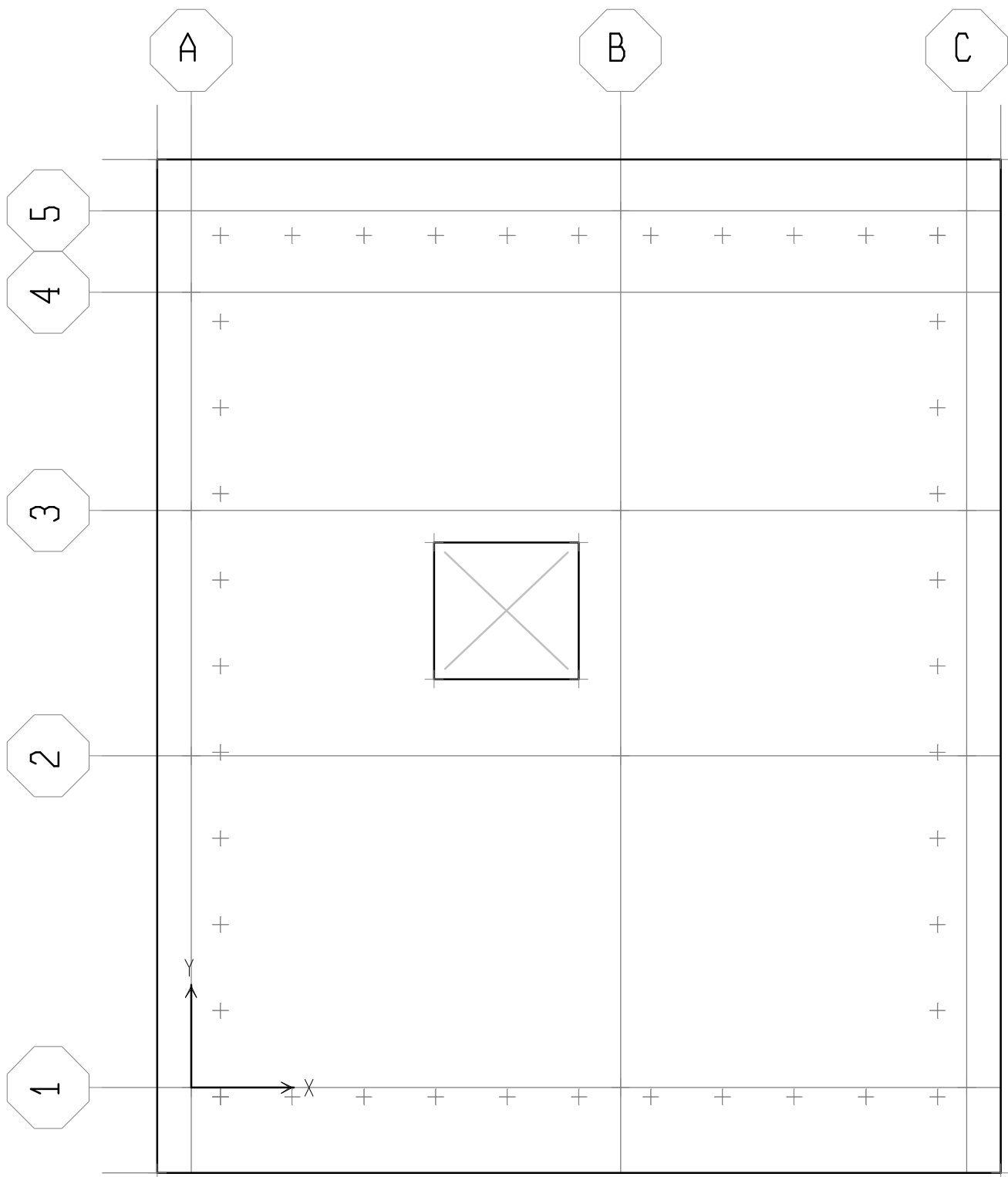

IN.txt

| P O I N T | L O A D S | Load Case | DEAD     |
|-----------|-----------|-----------|----------|
| POINT     | VERTICAL  | MOMENT-X  | MOMENT-Y |
| 1         | 35.51     | -0.559    | -1.369   |
| 2         | 78.14     | -1.041    | -0.061   |
| 3         | 50.14     | -0.012    | 0.566    |
| 4         | 60.67     | -0.451    | -1.609   |
| 5         | 120.64    | -0.228    | 0.492    |
| 6         | 58.93     | -0.148    | 0.890    |
| 7         | 85.58     | -0.779    | -1.629   |
| 8         | 129.36    | -0.318    | 0.578    |
| 9         | 61.57     | -0.486    | 0.980    |
| 10        | 60.63     | 1.236     | -1.082   |
| 11        | 81.40     | 0.851     | -0.282   |
| 12        | 48.76     | 0.388     | 0.998    |

SAFE v8.1.0 File: 01 Ton-m Units PAGE 4  
April 26, 2016 14:08

S U R F A C E L O A D S Load Case DEAD

AREA UNIFORM-W

1 0.480

SAFE v8.1.0 File: 01 Ton-m Units PAGE 5  
April 26, 2016 14:08

| P O I N T | L O A D S | Load Case | LIVE     |
|-----------|-----------|-----------|----------|
| POINT     | VERTICAL  | MOMENT-X  | MOMENT-Y |
| 1         | 1.26      | -0.030    | -0.085   |
| 2         | 0.58      | -0.010    | -0.061   |
| 3         | -0.24     | -0.001    | -0.072   |
| 4         | 11.44     | -0.335    | -0.252   |
| 5         | 11.80     | -0.148    | 0.270    |
| 6         | -0.14     | -0.009    | -0.083   |
| 7         | 12.48     | 0.165     | -0.261   |
| 8         | 12.81     | 0.132     | 0.275    |
| 9         | -0.11     | 0.005     | -0.084   |
| 10        | 0.70      | 0.012     | -0.086   |
| 11        | 0.53      | 0.004     | -0.069   |
| 12        | -0.20     | -0.001    | -0.078   |

S U R F A C E L O A D S Load Case LIVE

AREA UNIFORM-W

1 0.300

SAFE v8.1.0 File: 01 Ton-m Units PAGE 7  
April 26, 2016 14:08

| P O I N T | L O A D S | Load Case | EX       |
|-----------|-----------|-----------|----------|
| POINT     | VERTICAL  | MOMENT-X  | MOMENT-Y |
| 1         | -31.01    | -0.428    | 29.468   |
| 2         | -18.23    | -0.531    | 35.266   |
| 3         | 24.67     | 0.173     | 30.896   |
| 4         | -29.03    | 0.413     | 29.691   |
| 5         | -13.81    | 0.353     | 35.435   |
| 6         | 45.20     | 0.273     | 30.910   |
| 7         | -31.13    | 0.311     | 2.713    |
| 8         | -13.91    | 0.298     | 35.457   |
| 9         | 45.65     | 0.264     | 3.922    |

IN.txt

|    |        |       |        |
|----|--------|-------|--------|
| 10 | -29.40 | 0.270 | 29.760 |
| 11 | -14.75 | 0.238 | 35.563 |
| 12 | 45.76  | 0.211 | 30.966 |

| P O I N T | L O A D S | Load Case | EY       |
|-----------|-----------|-----------|----------|
| POINT     | VERTICAL  | MOMENT-X  | MOMENT-Y |
| 1         | 45.54     | -29.378   | 1.714    |
| 2         | 45.61     | -25.888   | 2.186    |
| 3         | 21.72     | -24.340   | 1.431    |
| 4         | -40.13    | -32.633   | 0.081    |
| 5         | 19.56     | -31.356   | 0.557    |
| 6         | 13.68     | -29.534   | 0.266    |
| 7         | -0.31     | -30.689   | -0.408   |
| 8         | -26.56    | -30.920   | -0.998   |
| 9         | -21.29    | -29.156   | -0.646   |
| 10        | -37.09    | -27.048   | -1.881   |
| 11        | -34.43    | -25.215   | -2.239   |
| 12        | -16.31    | -23.885   | -1.961   |

SAFE v8.1.0 File: 01 Ton-m Units PAGE 9  
April 26, 2016 14:08

| P O I N T | L O A D S | Load Case | EXP      |
|-----------|-----------|-----------|----------|
| POINT     | VERTICAL  | MOMENT-X  | MOMENT-Y |
| 1         | -26.76    | -2.968    | 31.454   |
| 2         | -19.68    | -0.433    | 38.067   |
| 3         | 24.39     | 2.366     | 33.386   |
| 4         | -32.86    | -2.312    | 30.339   |
| 5         | -14.04    | 0.541     | 36.301   |
| 6         | 45.04     | 2.879     | 31.663   |
| 7         | -30.48    | -2.263    | 2.210    |
| 8         | -13.67    | 0.483     | 34.754   |
| 9         | 46.54     | 2.839     | 3.314    |
| 10        | -30.38    | -2.047    | 27.328   |
| 11        | -13.53    | 0.394     | 32.719   |
| 12        | 45.44     | 2.372     | 28.445   |

SAFE v8.1.0 File: 01 Ton-m Units PAGE 10  
April 26, 2016 14:08

| P O I N T | L O A D S | Load Case | EXN      |
|-----------|-----------|-----------|----------|
| POINT     | VERTICAL  | MOMENT-X  | MOMENT-Y |
| 1         | -35.27    | 2.112     | 27.483   |
| 2         | -16.79    | -0.629    | 32.465   |
| 3         | 24.95     | -2.020    | 28.406   |
| 4         | -25.20    | 3.138     | 29.043   |
| 5         | -13.58    | 0.166     | 34.568   |
| 6         | 45.37     | -2.332    | 30.156   |
| 7         | -31.78    | 2.884     | 3.216    |
| 8         | -14.15    | 0.113     | 36.161   |
| 9         | 44.76     | -2.312    | 1.529    |
| 10        | -28.42    | 2.587     | 32.192   |
| 11        | -15.98    | 0.083     | 38.407   |
| 12        | 46.08     | -1.951    | 33.488   |

SAFE v8.1.0 File: 01 Ton-m Units PAGE 11  
April 26, 2016 14:08

| P O I N T | L O A D S | Load Case | EYP      |
|-----------|-----------|-----------|----------|
| POINT     | VERTICAL  | MOMENT-X  | MOMENT-Y |

IN.txt

|    |        |         |           |
|----|--------|---------|-----------|
| 1  | 42.09  | -27.316 | 0.102     |
| 2  | 46.79  | -25.967 | -0.088    |
| 3  | 21.95  | -26.120 | -0.591    |
| 4  | -37.02 | -30.421 | -0.445    |
| 5  | 19.75  | -31.509 | -0.146    |
| 6  | 13.81  | -31.649 | -0.346    |
| 7  | -0.84  | -28.600 | 7.726E-04 |
| 8  | -26.75 | -31.071 | -0.427    |
| 9  | -22.01 | -31.247 | -0.152    |
| 10 | -36.29 | -25.167 | 0.094     |
| 11 | -35.43 | -25.341 | 0.070     |
| 12 | -16.05 | -25.640 | 0.087     |

SAFE v8.1.0 File: 01 Ton-m Units PAGE 12  
April 26, 2016 14:08

P O I N T L O A D S Load Case EYN

| POINT | VERTICAL | MOMENT-X | MOMENT-Y |
|-------|----------|----------|----------|
| 1     | 49.00    | -31.441  | 3.326    |
| 2     | 44.44    | -25.808  | 4.460    |
| 3     | 21.49    | -22.559  | 3.453    |
| 4     | -43.24   | -34.845  | 0.607    |
| 5     | 19.38    | -31.204  | 1.261    |
| 6     | 13.55    | -27.419  | 0.878    |
| 7     | 0.22     | -32.779  | -0.816   |
| 8     | -26.36   | -30.770  | -1.569   |
| 9     | -20.57   | -27.065  | -1.139   |
| 10    | -37.89   | -28.929  | -3.856   |
| 11    | -33.44   | -25.088  | -4.548   |
| 12    | -16.56   | -22.130  | -4.008   |

SAFE v8.1.0 File: 01 Ton-m Units PAGE 13  
April 26, 2016 14:08

P O I N T L O A D S Load Case LW

| POINT | VERTICAL | MOMENT-X | MOMENT-Y |
|-------|----------|----------|----------|
| 1     | 3.47     | -0.088   | -0.052   |
| 2     | 6.48     | -0.140   | -0.153   |
| 3     | 4.03     | 0.007    | 0.138    |
| 4     | 3.16     | 0.061    | -0.024   |
| 5     | 9.99     | 0.093    | -0.244   |
| 6     | 5.30     | -0.011   | 0.226    |
| 7     | 4.76     | -0.179   | -0.032   |
| 8     | 11.78    | -0.145   | -0.236   |
| 9     | 5.59     | -0.017   | 0.238    |
| 10    | 4.04     | 0.169    | -0.021   |
| 11    | 7.29     | 0.165    | -0.172   |
| 12    | 3.26     | 0.004    | 0.137    |

SAFE v8.1.0 File: 01 Ton-m Units PAGE 14  
April 26, 2016 14:08

P O I N T L O A D S Load Case L05

| POINT | VERTICAL | MOMENT-X | MOMENT-Y |
|-------|----------|----------|----------|
| 1     | 5.14     | -0.135   | -0.082   |
| 2     | 10.19    | -0.217   | -0.247   |
| 3     | 7.03     | 0.026    | 0.221    |
| 4     | 4.09     | 0.092    | -0.036   |
| 5     | 14.00    | 0.140    | -0.376   |
| 6     | 8.10     | -0.026   | 0.347    |
| 7     | 6.42     | -0.279   | -0.047   |
| 8     | 16.40    | -0.230   | -0.362   |
| 9     | 8.51     | -0.035   | 0.366    |



IN.txt

|    |       |        |        |
|----|-------|--------|--------|
| 10 | 0.10  | 0.258  | -0.028 |
| 11 | 11.08 | 0.247  | -0.260 |
| 12 | 5.00  | -0.002 | 0.215  |

SAFE v8.1.0 File: 01 Ton-m Units PAGE 15  
April 26, 2016 14:08

# P O I N T L O A D S Load Case S

| POINT | VERTICAL | MOMENT-X   | MOMENT-Y |
|-------|----------|------------|----------|
| 1     | 1.15     | -0.001     | -0.002   |
| 2     | 2.46     | -0.002     | -0.004   |
| 3     | 1.74     | -3.798E-04 | 0.003    |
| 4     | 1.32     | -2.936E-04 | -0.002   |
| 5     | 3.19     | -7.047E-04 | -0.004   |
| 6     | 1.97     | -1.839E-04 | 0.004    |
| 7     | 1.83     | -0.002     | -0.001   |
| 8     | 3.46     | -4.807E-04 | -0.004   |
| 9     | 2.07     | 6.189E-04  | 0.004    |
| 10    | 1.44     | 0.003      | -0.002   |
| 11    | 2.68     | 0.003      | -0.003   |
| 12    | 1.24     | 0.002      | 0.004    |

SAFE v8.1.0 File: 01 Ton-m Units PAGE 16  
April 26, 2016 14:08

# S L A B S E C T I O N P R O P E R T I E S

| SECTION LABEL | ELASTIC MODULUS | POISSONS RATIO | SLAB THICK I | SLAB THICK J | SLAB THICK I J | UNIT WEIGHT |
|---------------|-----------------|----------------|--------------|--------------|----------------|-------------|
| FUND          | 2544344         | 0.150          | 0.800        | 0.800        | 0.800          | 2.500       |

SAFE v8.1.0 File: 01 Ton-m Units PAGE 17  
April 26, 2016 14:08

# S L A B S E C T I O N P R O P E R T I E S

| SECTION LABEL | TOTAL WEIGHT |
|---------------|--------------|
| FUND          | 368.181      |

SAFE v8.1.0 File: 01 Ton-m Units PAGE 18  
April 26, 2016 14:08

# S U P P O R T P R O P E R T I E S

| SUPPORT LABEL | CONSTANT KZZ | CONSTANT KRX | CONSTANT KRY |
|---------------|--------------|--------------|--------------|
| SOIL1         | 1020.000     |              |              |

SAFE v8.1.0 File: 01 Ton-m Units PAGE 19  
April 26, 2016 14:08

# S T A T I C L O A D C A S E S

| STATIC CASE | CASE TYPE | SELF WT FACTOR | DEFLECTION FACTOR |
|-------------|-----------|----------------|-------------------|
| DEAD        | DEAD      | 1.0000         | 1.0000            |
| LIVE        | LIVE      | 0.0000         | 1.0000            |
| EX          | QUAKE     | 0.0000         | 1.0000            |
| EY          | QUAKE     | 0.0000         | 1.0000            |
| EXP         | QUAKE     | 0.0000         | 1.0000            |
| EXN         | QUAKE     | 0.0000         | 1.0000            |
| EYP         | QUAKE     | 0.0000         | 1.0000            |

IN.txt

|      |       |        |        |
|------|-------|--------|--------|
| EYN  | QUAKE | 0.0000 | 1.0000 |
| LW   | LIVE  | 0.0000 | 1.0000 |
| LRED | LIVE  | 0.0000 | 1.0000 |
| LO5  | LIVE  | 0.0000 | 1.0000 |
| S    | SNOW  | 0.0000 | 1.0000 |

SAFE v8.1.0 File: 01 Ton-m Units PAGE 20  
April 26, 2016 14:08

# L O A D C O M B I N A T I O N D A T A

| COMBO  | CASE | TYPE  | FACTOR |
|--------|------|-------|--------|
| PRESS1 | DEAD | DEAD  | 1.000  |
|        | LIVE | LIVE  | 1.000  |
|        | LW   | LIVE  | 1.000  |
|        | LRED | LIVE  | 1.000  |
|        | LO5  | LIVE  | 1.000  |
|        | S    | SNOW  | 1.000  |
| PRESS2 | DEAD | DEAD  | 0.750  |
|        | LIVE | LIVE  | 0.750  |
|        | LW   | LIVE  | 0.750  |
|        | LRED | LIVE  | 0.750  |
|        | LO5  | LIVE  | 0.750  |
|        | S    | SNOW  | 0.750  |
|        | EX   | QUAKE | 0.750  |
| PRESS3 | DEAD | DEAD  | 0.750  |
|        | LIVE | LIVE  | 0.750  |
|        | LW   | LIVE  | 0.750  |
|        | LRED | LIVE  | 0.750  |
|        | LO5  | LIVE  | 0.750  |
|        | S    | SNOW  | 0.750  |
|        | EX   | QUAKE | -0.750 |
| PRESS4 | DEAD | DEAD  | 0.750  |
|        | LIVE | LIVE  | 0.750  |
|        | LW   | LIVE  | 0.750  |
|        | LRED | LIVE  | 0.750  |
|        | LO5  | LIVE  | 0.750  |
|        | S    | SNOW  | 0.750  |
|        | EY   | QUAKE | 0.750  |
| PRESS5 | DEAD | DEAD  | 0.750  |
|        | LIVE | LIVE  | 0.750  |
|        | LW   | LIVE  | 0.750  |
|        | LRED | LIVE  | 0.750  |
|        | LO5  | LIVE  | 0.750  |
|        | S    | SNOW  | 0.750  |
|        | EY   | QUAKE | -0.750 |
| PRESS6 | DEAD | DEAD  | 0.750  |
|        | LIVE | LIVE  | 0.750  |
|        | LW   | LIVE  | 0.750  |
|        | LRED | LIVE  | 0.750  |
|        | LO5  | LIVE  | 0.750  |
|        | S    | SNOW  | 0.750  |
|        | EXP  | QUAKE | 0.750  |
| PRESS7 | DEAD | DEAD  | 0.750  |
|        | LIVE | LIVE  | 0.750  |
|        | LW   | LIVE  | 0.750  |
|        | LRED | LIVE  | 0.750  |
|        | LO5  | LIVE  | 0.750  |
|        | S    | SNOW  | 0.750  |
|        | EXP  | QUAKE | -0.750 |
| PRESS8 |      |       |        |

IN.txt

|         |      |       |        |
|---------|------|-------|--------|
|         | DEAD | DEAD  | 0.750  |
|         | LIVE | LIVE  | 0.750  |
|         | LW   | LIVE  | 0.750  |
|         | LRED | LIVE  | 0.750  |
|         | LO5  | LIVE  | 0.750  |
|         | S    | SNOW  | 0.750  |
|         | EYP  | QUAKE | 0.750  |
| PRESS9  |      |       |        |
|         | DEAD | DEAD  | 0.750  |
|         | LIVE | LIVE  | 0.750  |
|         | LW   | LIVE  | 0.750  |
|         | LRED | LIVE  | 0.750  |
|         | LO5  | LIVE  | 0.750  |
|         | S    | SNOW  | 0.750  |
|         | EYP  | QUAKE | -0.750 |
| PRESS10 |      |       |        |
|         | DEAD | DEAD  | 0.750  |
|         | LIVE | LIVE  | 0.750  |
|         | LW   | LIVE  | 0.750  |
|         | LRED | LIVE  | 0.750  |
|         | LO5  | LIVE  | 0.750  |
|         | S    | SNOW  | 0.750  |
|         | EXN  | QUAKE | 0.750  |
| PRESS11 |      |       |        |
|         | DEAD | DEAD  | 0.750  |
|         | LIVE | LIVE  | 0.750  |
|         | LW   | LIVE  | 0.750  |
|         | LRED | LIVE  | 0.750  |
|         | LO5  | LIVE  | 0.750  |
|         | S    | SNOW  | 0.750  |
|         | EXN  | QUAKE | -0.750 |
| PRESS12 |      |       |        |
|         | DEAD | DEAD  | 0.750  |
|         | LIVE | LIVE  | 0.750  |
|         | LW   | LIVE  | 0.750  |
|         | LRED | LIVE  | 0.750  |
|         | LO5  | LIVE  | 0.750  |
|         | S    | SNOW  | 0.750  |
|         | EYN  | QUAKE | 0.750  |
| PRESS13 |      |       |        |
|         | DEAD | DEAD  | 0.750  |
|         | LIVE | LIVE  | 0.750  |
|         | LW   | LIVE  | 0.750  |
|         | LRED | LIVE  | 0.750  |
|         | LO5  | LIVE  | 0.750  |
|         | S    | SNOW  | 0.750  |
|         | EYN  | QUAKE | -0.750 |

SAFE v8.1.0 File: 01 Ton-m Units PAGE 21  
April 26, 2016 14:08

# GROUP WEIGHT DATA

GROUP Wt

ALL 368.181